

BEFORE STARTING INSTALLATION  
TURN OFF THE POWER SUPPLY

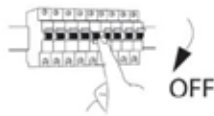

Reference	Supply voltage	Frequency	Power (W)	CCT	Dimensions(mm)	Version
302470	220-240V	50/60Hz	18-22/26-30	4000K	595x595	ON/OFF MULTIPOWER WHITE
302625	220-240V	50/60Hz	18-22/26-30	3000K	595x595	ON/OFF MULTIPOWER WHITE
302589	220-240V	50/60Hz	18-22/26-30	4000K	595x595	ON/OFF MULTIPOWER BLACK
302627	220-240V	50/60Hz	18-22/26-30	3000K	595x595	ON/OFF MULTIPOWER BLACK
302444	220-240V	50/60Hz	28	4000K	595x595	DALI 2 MULTIPOWER WHITE
302626	220-240V	50/60Hz	28	3000K	595x595	DALI 2 MULTIPOWER WHITE
302607	220-240V	50/60Hz	28	4000K	595x595	DALI 2 MULTIPOWER BLACK
302628	220-240V	50/60Hz	28	3000K	595x595	DALI 2 MULTIPOWER BLACK

## MAINTENANCE

Interchangeable LED modules:

Reference	Color	CCT	Dimensions(mm)
302469	White	4000K	72 x 72 x 32mm
302629	White	3000K	72 x 72 x 32mm
302608	Black	4000K	72 x 72 x 32mm
302638	Black	3000K	72 x 72 x 32mm

## DISTANCE BETWEEN LIGHTING LIGHT AND THERMAL INSULATION

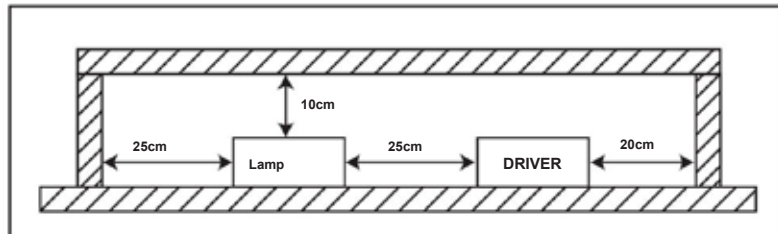

## FACILITY

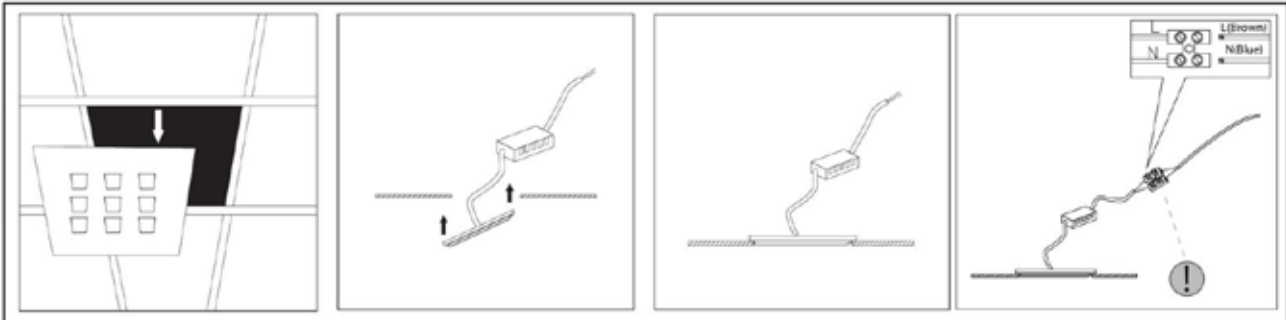

## SAFETY NOTICE

- Read the instructions carefully before use and keep these instructions for as long as you use the appliance.
- Assembly and maintenance are reserved for qualified people who can work on products that must be manually connected to 230V current.
- Before any assembly action, cut off the power supply.
- The flexible exterior cable of this luminaire cannot be replaced; if the cable is damaged, the luminaire must be destroyed.
- Caution, risk of electric shock when opening the product.
- This luminaire has a remote power supply, simply connect the luminaire to a 220-230VAC electrical inlet to operate it.
- The remote aspect of the power supply has an impact on the design of the luminaire and its installation and use. For example, a luminaire with a remote power supply is smaller and lighter to be installed in narrow or difficult to access places.
- Do not put any coating such as paint on the fixture.
- If an abnormality occurs, turn off the power immediately and contact the dealer.
- Do not unplug the power cable from the luminaire side when the power supply is on.
- The terminal block is not included; installation may require advice from a qualified person.
- Luminaire designed for direct installation on normally flammable surfaces.
- Do not look at the luminaire during normal use for more than 10 seconds; this can be dangerous for the eyes.
- The luminaire should be positioned in such a way that prolonged looking at the luminaire at a distance of less than 0.20 m is not possible.
- This product meets all the essential requirements of each of the directives that apply to it.
- At the end of its life, this product must be collected separately and must not be mixed with other household waste to respect the health and safety of people and to conserve natural resources.

## MAINTENANCE AND END OF LIFE



This symbol indicates that this product should not be disposed of with waste

classic household appliances according to European legislation 2012/19/EU.

To limit the risks to the environment and health caused by the uncontrolled discharge of waste and to promote the reuse of these materials, products must be recycled. To do this, use the collection networks in your region or contact your retailer.



This product contains a light source of energy efficiency class:



# 302607