

Date	Revision
1.6.2022	2

Read these instructions before installation and retain. This equipment should be installed by a competent electrician 

## Important Information

We recommend that luminaires are installed by a qualified electrician ensuring the installation complies with current IEE wiring regulations BS7671:2018 & local building control.

- BELL will not accept responsibility for any claims arising from a poor installation.
- Operating Temperature 0°C to +35°C.
- External use only.

This product may contain substances that can be hazardous to the environment if not disposed of properly. Electrical and electronic equipment should never be disposed of with general household waste but must be separated for its correct treatment and recovery. Where possible recycle your packaging.



## Replacement lamps (non integrated version)

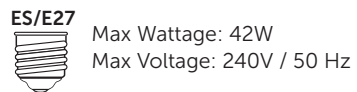

## Wiring Details (Class II)

Double insulated, with earth provision 

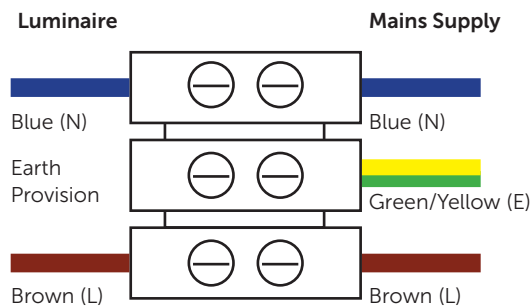

## Installation Procedure Full Lantern

- Unscrew capping nuts on front of the fitting, then remove terminal housing cover (fig 1).
- Hold the terminal housing cover up to the wall in the desired fixing position and mark hole position. (this fitting should not be mounted to a wet or damp surface such as freshly painted or plastered walls (fig 2).
- Cut a hole in the rubber grommet within the terminal housing and feed the mains cable through (fig 3).
- Drill holes in the wall on the previously marked positions and fix securely.
- Connect the live and neutral cables into the 3 way terminal block and then relocate the connector in to the terminal housing (fig 4)
- Position the fitting onto the terminal housing that was secured to the wall. Secure the capping nuts.
- Turn on mains supply to test the fitting.

## ES/E27 Version Only

- Remove the lantern lid by unfastening the fixings and screw ES/E27 lamp in to the lamp holder, replace lantern lid.
- Turn on mains supply to test the fitting.

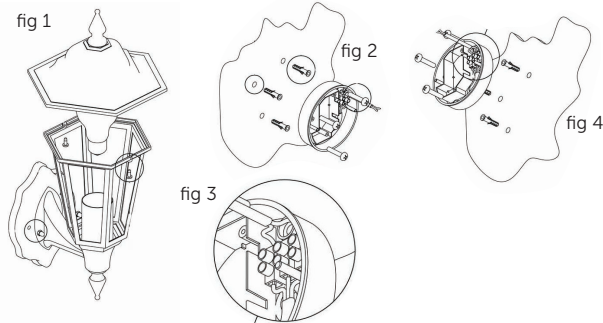

## PIR Settings

- Detection range up to 10m when mounted at 2.4m
- Detection angle 90 degrees / Time delay 60 seconds

This PIR has a manual override function which can be set by following the steps below. Turn the switch off and on twice within a 2 second period to enable the manual override setting. To reset to standard mode turn the fitting off for 10 seconds and switch back on.

## Installation Procedure Half Lantern

- Remove the 2 screws securing the front cover to the back.
- Hold the rear cover to the wall in the desired fixing position and mark hole position (this fitting should not be mounted to a wet or damp surface such as freshly painted or plastered wall.
- Cut a hole in the rubber grommet within the terminal housing and feed the mains cable through.
- Drill holes in the wall on the previously marked positions and fix securely.
- Connect the live and neutral cables into the 3 way terminal block and then relocate the connector in to the terminal housing.
- Secure the rear cover using the holes drilled previously with the supplied screws.
- Locate the front cover of the fitting on to the back cover that was secured to the wall. Secure to the fitting using the screws removed in step 1.
- Turn on the mains supply to test the fitting.

## ES/E27 Version Only

- Screw ES/E27 lamp in to the lampholder.
- Turn on mains supply to test the fitting.

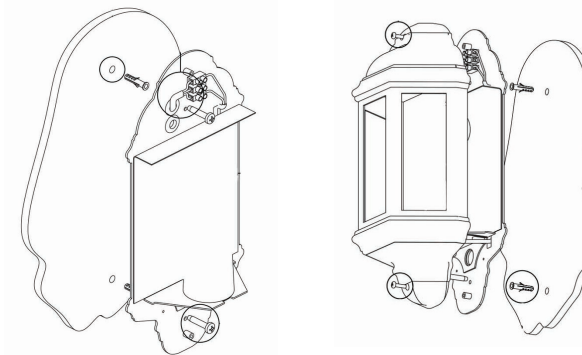

Technical Helpline +44 (0)1924 893380

www.bellighting.co.uk

British Electric Lamps Ltd  
Unit A Foxbridge Way, Normanton Industrial Estate  
Normanton, West Yorkshire. WF6 1TN

T: +44 (0)1924 893380 F: +44 (0)1924 894320 E: sales@bellighting.co.uk

www.bellighting.co.uk