

### Important Information

We recommend that luminaires are installed by a qualified electrician ensuring the installation complies with current IEE wiring regulations BS7671:2018 & local building control.

- BELL will not accept responsibility for any claims arising from a poor installation.
- The light source of this luminaire is not replaceable: when the light source reaches end of life, the whole luminaire must be replaced.
- Operating Temperature 0°C to +35°C.

**Warning Before installation ensure power is disconnected.**

This product may contain substances that can be hazardous to the environment if not disposed of properly. Electrical and electronic equipment should never be disposed of with general household waste but must be separated for its correct treatment and recovery.

Where possible recycle your packaging.



**Read these instructions before installation and retain for future reference**  
**This equipment should be installed by a competent electrician**

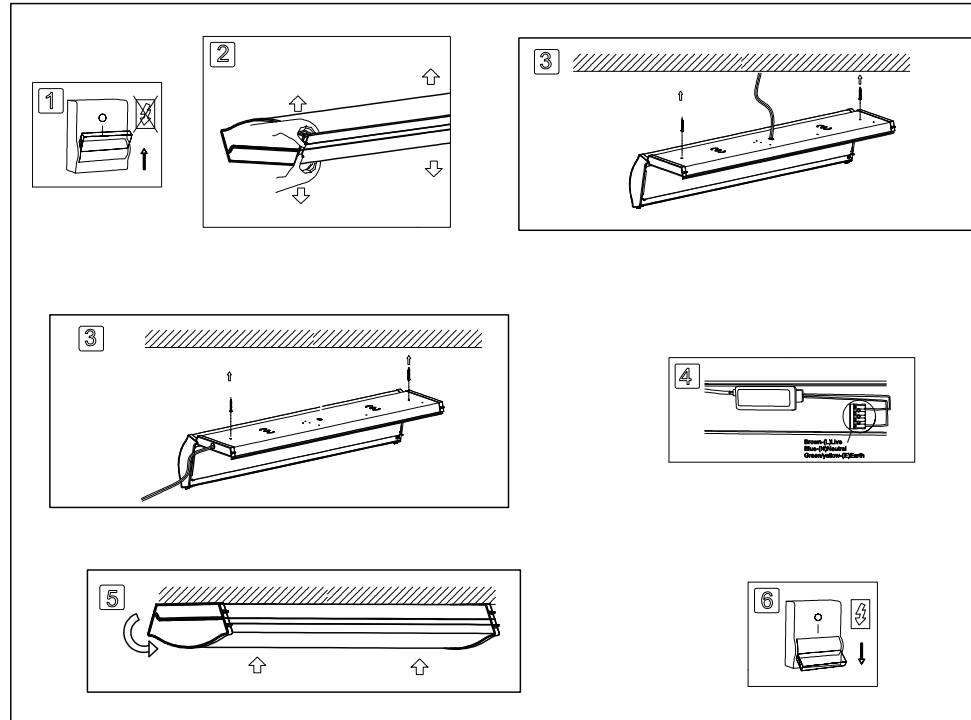

SIZE	TYPE	DIP SWITCH																					
1200mm	STANDARD	<table border="1"> <tr><td>DN</td><td>1</td><td>2</td></tr> <tr><td>OFF</td><td>■</td><td>■</td></tr> </table>	DN	1	2	OFF	■	■	<table border="1"> <tr><td>DN</td><td>1</td><td>2</td></tr> <tr><td>OFF</td><td>■</td><td>■</td></tr> </table>	DN	1	2	OFF	■	■								
DN	1	2																					
OFF	■	■																					
DN	1	2																					
OFF	■	■																					
1200mm	DALI	<table border="1"> <tr><td>DN</td><td>1</td><td>2</td><td>3</td></tr> <tr><td>OFF</td><td>■</td><td>■</td><td>■</td></tr> </table>	DN	1	2	3	OFF	■	■	■	<table border="1"> <tr><td>DN</td><td>1</td><td>2</td><td>3</td></tr> <tr><td>OFF</td><td>■</td><td>■</td><td>■</td></tr> </table>	DN	1	2	3	OFF	■	■	■				
DN	1	2	3																				
OFF	■	■	■																				
DN	1	2	3																				
OFF	■	■	■																				
1500mm	STANDARD	<table border="1"> <tr><td>DN</td><td>1</td><td>2</td></tr> <tr><td>OFF</td><td>■</td><td>■</td></tr> </table>	DN	1	2	OFF	■	■	<table border="1"> <tr><td>DN</td><td>1</td><td>2</td></tr> <tr><td>OFF</td><td>■</td><td>■</td></tr> </table>	DN	1	2	OFF	■	■								
DN	1	2																					
OFF	■	■																					
DN	1	2																					
OFF	■	■																					
1500mm	DALI	<table border="1"> <tr><td>DN</td><td>1</td><td>2</td><td>3</td><td>4</td></tr> <tr><td>OFF</td><td>■</td><td>■</td><td>■</td><td>■</td></tr> </table>	DN	1	2	3	4	OFF	■	■	■	■	<table border="1"> <tr><td>DN</td><td>1</td><td>2</td><td>3</td><td>4</td></tr> <tr><td>OFF</td><td>■</td><td>■</td><td>■</td><td>■</td></tr> </table>	DN	1	2	3	4	OFF	■	■	■	■
DN	1	2	3	4																			
OFF	■	■	■	■																			
DN	1	2	3	4																			
OFF	■	■	■	■																			
1800mm	STANDARD	<table border="1"> <tr><td>DN</td><td>1</td><td>2</td></tr> <tr><td>OFF</td><td>■</td><td>■</td></tr> </table>	DN	1	2	OFF	■	■	<table border="1"> <tr><td>DN</td><td>1</td><td>2</td></tr> <tr><td>OFF</td><td>■</td><td>■</td></tr> </table>	DN	1	2	OFF	■	■								
DN	1	2																					
OFF	■	■																					
DN	1	2																					
OFF	■	■																					
1800mm	DALI	<table border="1"> <tr><td>DN</td><td>1</td><td>2</td><td>3</td><td>4</td></tr> <tr><td>OFF</td><td>■</td><td>■</td><td>■</td><td>■</td></tr> </table>	DN	1	2	3	4	OFF	■	■	■	■	<table border="1"> <tr><td>DN</td><td>1</td><td>2</td><td>3</td><td>4</td></tr> <tr><td>OFF</td><td>■</td><td>■</td><td>■</td><td>■</td></tr> </table>	DN	1	2	3	4	OFF	■	■	■	■
DN	1	2	3	4																			
OFF	■	■	■	■																			
DN	1	2	3	4																			
OFF	■	■	■	■																			
		■ = SWITCH	<table border="1"> <tr><td>HIGH</td></tr> <tr><td>LOW</td></tr> </table>	HIGH	LOW																		
HIGH																							
LOW																							