

Emergency Range

Installation instructions for JC50321 Emergency Bulkhead



Warnings & Cautions

- To avoid electric shock, serious injury or property damage, isolate power before installing, removing or servicing the product.
- It is recommended that luminaires are installed by a qualified electrician to ensure the installation complies with the local current wiring regulations.
- It may be necessary to upgrade your MCBs to allow for increased inrush current.
- This product is designed for connection to a 220-240V~ 50/60Hz.
- It is recommended that the ambient room temperature should not exceed 30°C.
- Read instructions and check that you have all of the tools and accessories required to complete the installation correctly. Isolate power supply before starting installation.
- Do not carry out insulation tests with the product connected to the circuit.
- Any broken or damaged parts should be replaced as soon as possible. JCC will not accept responsibility for claims arising from sub-standard installations; which will void the warranty.
- This luminaire is suitable for indoor and outdoor use.
- All testing should be carried out in accordance to EN 50172:2004

INSTALLATION

ENGLISH

3W 220-240V~ 50/60Hz - Class I
 Colour temp: 6000K Ra: 85

Light source: Integral LED
 Total circuit Wattage: 3W(AC)
 Total circuit Wattage: 6.48W(DC)
 Luminous flux: 122 lumens(AC)
 Luminous flux: 120 lumens(DC)

Maintained(3M)
 + on/off Switched
 + Emergency
 (remove link)

 U/sw Live: Brown
 Neutral: Blue
 Sw/Live: Black

Maintained(3M)
 + Light on 24/7
 + Emergency
 (keep link)

 U/sw Live: Brown
 Neutral: Blue
 Sw/Live(linked)

Non-Maintained(3NM)
 + Light off 24/7
 + Emergency
 (remove link)

 U/sw Live: Brown
 Neutral: Blue
 (do not use)

- Remove the two screws holding the diffuser to gain access to the interior.
- Release the LED tray to access the mains input terminal. This is hinged so the LED tray remains attached to the body.
- Cable entry is available through rear, top and bottom or both ends. Ensure appropriate grommets or compression couplings are used to maintain the IP65 rating where required.
- Connect the mains input supply as indicated on the left as per the required operation.
- Connect the emergency battery leads to the circuit board where indicated.
- Relocate the LED tray, ensuring it is secured using the securing tab.
- Refit the diffuser ensuring there is a good seal to maintain the IP65 rating.
- Switch on mains supply and test for operation(allow 24hrs for batteries to charge). Correct operation and charging is indicated by the green light being on
- Fit the legends on the front of the diffuser to suit the application from the four choices indicated on the right which are included.
- Familiarise yourself with the enclosed emergency fittings test record sheet and ensure it is completed as required and left with the end user.

Supplied legends:

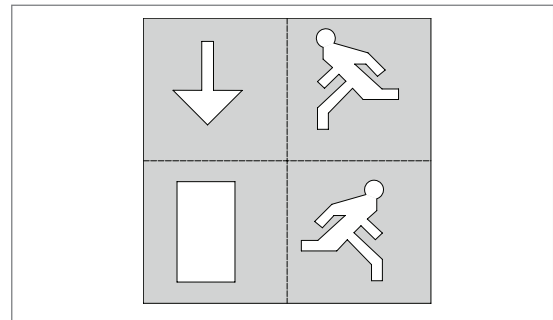

Profile & Dimensions

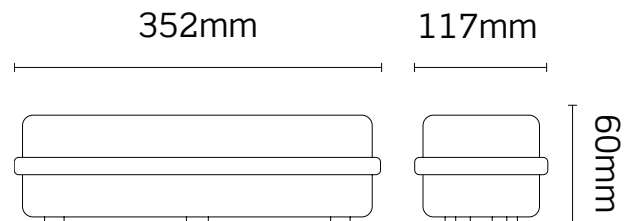

All dimensions in millimetres

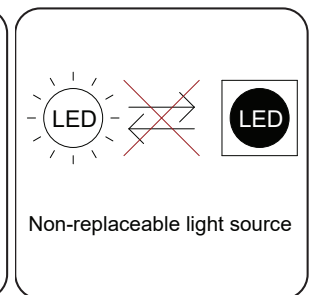
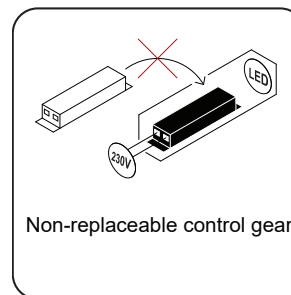

CE UK RoHS IP65 jcc.co.uk

Important warranty information

This product is supported by a 2-year standard warranty which will extend to 3 years if registered within the first year of purchase. (2 year on batteries). Please register at jcc.co.uk/warranty - Terms and conditions apply.

The installer will be asked to provide the following information, which is detailed on a label attached to the luminaire's chassis:
 Product Code/Date Code.

BS EN ISO9001 - 2015 - Registered Firm Certificate No. GB 1552

JCC Lighting Products Ltd. Innovation Centre, Beeding Close, Southern Cross Trading Estate, Bognor Regis, West Sussex, PO22 9TS, United Kingdom

Technical Support: +44(0)1243 838986 Customer Services: +44(0)1243 838999

V4_Apr_2021_GL

