

Emergency Range

Installation instructions for JC50302 Emergency Exit Blade

JCC | a **LEVITON** company

Warnings & Cautions

- To avoid electric shock, serious injury or property damage, isolate power before installing, removing or servicing the product.
- It is recommended that luminaires are installed by a qualified electrician to ensure the installation complies with the local current wiring regulations.
- It may be necessary to upgrade your MCBs to allow for increased inrush current.
- This product is designed for connection to a 220-240V~ 50/60Hz supply.
- It is recommended that the ambient room temperature should not exceed 30°C.
- Read instructions and check that you have all of the tools and accessories required to complete the installation correctly. Isolate power supply before starting installation.
- Do not carry out insulation tests with the product connected to the circuit.
- Any broken or damaged parts should be replaced as soon as possible. JCC will not accept responsibility for claims arising from sub-standard installations; which will void the warranty.
- This luminaire is for indoor use only.
- All testing should be carried out in accordance to EN 50172:2004.

INSTALLATION

ENGLISH

220-240V~ 50/60Hz - Class II 

Light source:	Integral LED
Total circuit Wattage:	2.8W(AC)
Total circuit Wattage:	2.88W(DC)
Luminous flux:	46 lumens(AC)
Luminous flux:	46 lumens(DC)
Efficacy:	16 LpcW(AC)
Efficacy:	16 LpcW(DC)
Ra:	78

Maintained(3M)
+ Light on 24/7



U/sw Live: Brown
Neutral: Blue

Non-Maintained(3NM)
+ Light off 24/7
+ Emergency

For non-maintained operation
remove jumper as instructed on
circuit board.

Installation

- To remove the back cover press the tabs at each end to release.
- Cable entry is available through the rear only.
- Use the back plate as a template to mark for holes to securing the fitting, ensuring suitable fixings are used for the intended location.
- For wall or ceiling mounting ensure that the cable entry is on the left and that the fitting is mounted with the test button and indicator light facing forward to the right hand side.
- For wall mouting, this will ensure that the fitting lays 90° to the wall surface and the blade in a vertical position.
- Connect the mains input supply as indicated above as per the required operation.
- Connect the emergency battery leads to the circuit board (top right hand corner - next to the batteries).
- For non-maintained operation, remove jumper as instructed on circuit board.
- Refit the body to the base.
- Using the 4 press clips supplied, fit the two corresponding legends to the blade to suit the application.
- Switch on mains supply and test for operation (allow 24hrs for batteries to charge).
- Familiarise yourself with the enclosed emergency fittings test record sheet and ensure it is completed as required and left with the end user.

Function test

- With mains supply on and green indicator light on, press the Test button to check function.
- Green indicator light will go off and the fitting will operate in emergency mode.
- Release the button and the inidicator light will come on and the fitting will then return to previous operation.

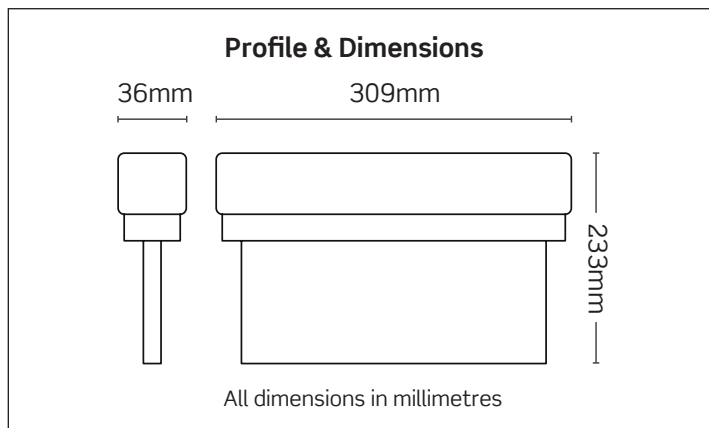

Legends not supplied

Available legends to order:
JC50308 - 1 x left & 1 x right running man
JC50310 - 2 x Down running man
JC50311 - 2 x Up running man

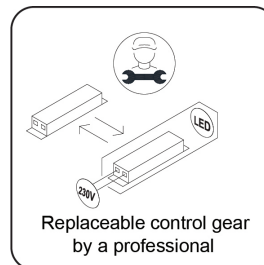
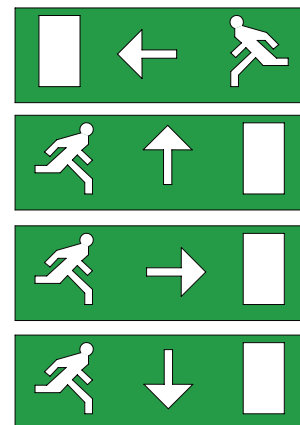

Replaceable control gear
by a professional

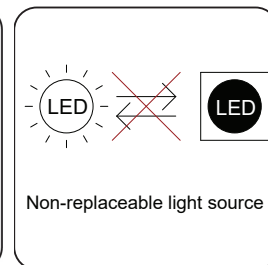

Non-replaceable light source

CE UK RoHS Compliant    IP20 **jcc.co.uk**

Important warranty information

This product is supported by a 2-year standard warranty which will extend to 3 years if registered within the first year of purchase. (2 year on batteries). Please register at jcc.co.uk/warranty - Terms and conditions apply.

The installer will be asked to provide the following information, which is detailed on a label attached to the luminaire's chassis:
Product Code/Date Code.

BS EN ISO9001 - 2015 - Registered Firm Certificate No. GB 1552
JCC Lighting Products Ltd. Lux Park, Chichester Business Park, City Fields Way, Tangmere, Chichester, West Sussex, PO20 2FT
Technical Support: +44(0)1243 838986 Customer Services: +44(0)1243 838999

V8_Sept_2022_RS

