

# Mainline Track Range

Installation instructions for JC14008 Power Feed for Track centre

## Warnings & Cautions

- To avoid electric shock, serious injury or property damage, isolate power before installing, removing or servicing the product.
- It is recommended that luminaires are installed by a qualified electrician to ensure the installation complies with the local current wiring regulations.
- Any broken or damaged parts should be replaced as soon as possible.
- JCC will not accept responsibility for claims arising from sub-standard installations; which will void the warranty.
- It may be necessary to upgrade your MCBs to allow for increased inrush current.
- Ensure that the mounting surface is both flat and stable.
- Read instructions and check that you have all of the tools and accessories required to complete the installation correctly. Isolate power supply before starting the installation.
- This product is designed for connection to a 240V~ 50Hz. 16 Amp max.
- This product is suitable for indoor use only.

## INSTALLATION

ENGLISH

### 240V 50Hz 16 Amp max. Class I Ⓢ

Available in black and white

### Installation procedure

Please note that both the internal profile of the track sections and the external profile of the connectors are asymmetrical: this feature has been incorporated to ensure the overall polarity of the system, i.e. phase can only be connected to phase and neutral will only connect to neutral (see Fig. 1a). The JC14008 is a power feed for track centre only. You can not use this to join two sections of track.

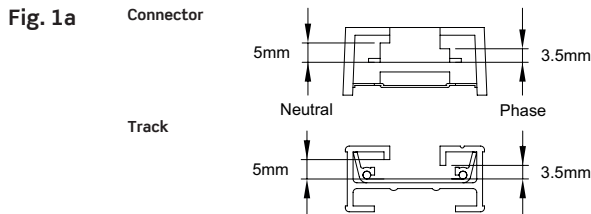

If you should experience any difficulties connecting Mainline components please check that they are correctly orientated. The phase side of the track can also be identified by the shallow groove running along its outer surface. This groove is a reference for the correct insertion of luminaires into the track during installation (see Fig. 1b).

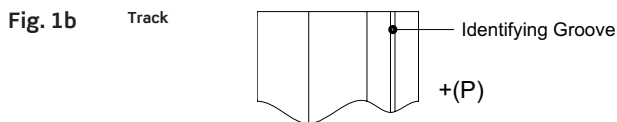

1. Fix metal ceiling bracket c/w stranded Earth cable to ceiling using suitable fixings and connect Earth wire to Earth on the lighting circuit.

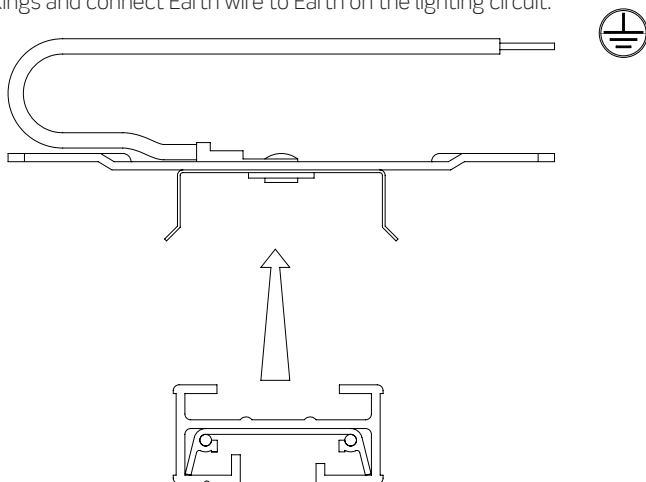

2. Locate track section into ceiling bracket (push fit).

3. Connect live and neutral to power feed track connector then insert power feed connector into the track section and then rotate to lock into position, ensuring the positive on the connector and track phase (P+) (Fig. 1b) are aligned.

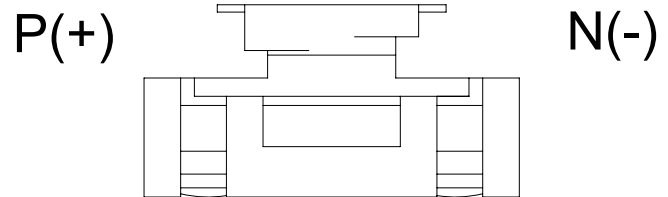

4. Fit the plastic safety cover with the retaining screw.

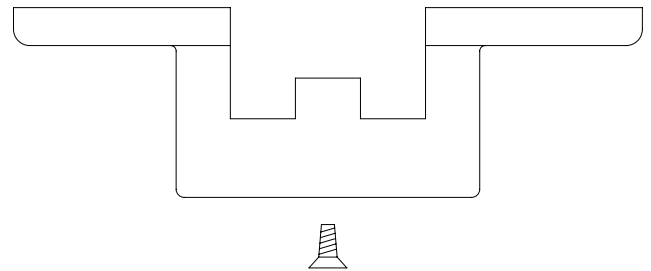

### Profile & Dimensions

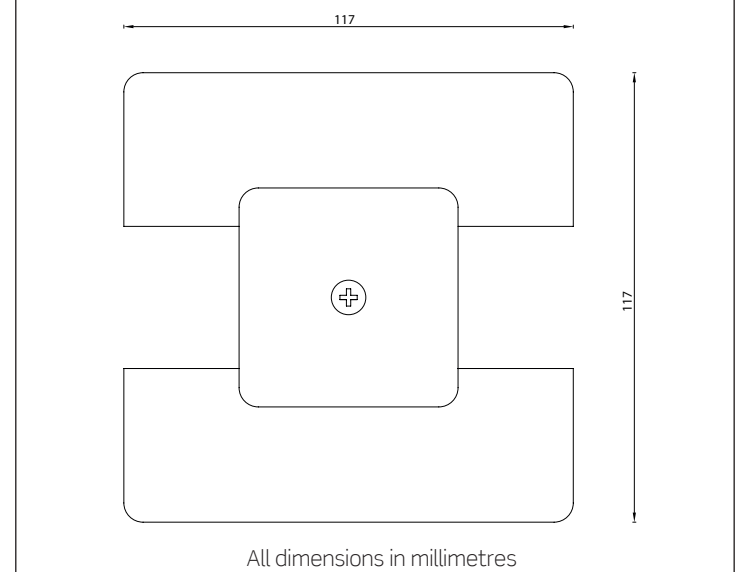

### Important warranty information

This product is supported by a 2-year standard warranty. (See website for terms and conditions).