

TIMEGUARD®

LED Ready PIR Up/Down Light



Model: UDSS2PIR
(Silver Finish)



Model: UDB2PIR
(Black Finish)

Installation & Operating Instructions

1. General Information

These instructions should be read carefully and retained for further reference and maintenance.

Note: Timeguard reserve the right to alter these instructions at any time. Up to date instructions will always be available for download at www.timeguard.com

2. Safety

- Before installation or maintenance, ensure the mains supply to the luminaire is switched off and the circuit supply fuses are removed or the circuit breaker turned off.
- It is recommended that a qualified electrician is consulted or used for the installation of this luminaire and install in accordance with the current IEE wiring and Building Regulations.
- Check that the total load on the circuit including when this luminaire is fitted does not exceed the rating of the circuit cable, fuse or circuit breaker.
- To clean use a clean dry cloth only. Do not use liquid cleaners.

3. Technical Specifications

- Mains Supply: 220-240V AC 50Hz
- Class Protection: Class I
- IP Rating: IP44
- Operating Temperature: 0° to 40°C
- PIR Switching Capacity: x2 35W Halogen or x2 15W LED

- PIR Detection Range: 4 - 7m at a 2m mounting height (adjustable)
- Detection Angle: 90° (Fixed)
- Time ON Adjustment: 10 seconds - 5 minutes
- (LUX) level adjustment: 10 - 2000
- Manual Override: Yes
- Construction: Stainless steel
- Dimensions (H x W x D): 221mm x 60mm x 100mm

4. Selecting a location

- The PIR has a number of detection zones at various horizontal and vertical angles as shown below.

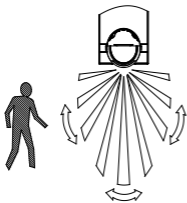

**Effective Approach Path
(ACROSS)**

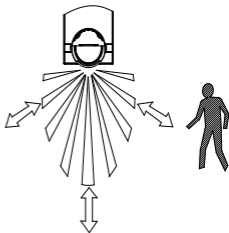

**Ineffective Approach Path
(TOWARDS)**

- A moving human body or object needs to cross one of these zones to activate the sensor. The optimum height for this is between 1.5m - 2m mounting height. Careful positioning of the luminaire is required to ensure the best performance from the PIR and the appointed approach path.

- Avoid positioning the luminaire near any sources of heat in and around the detection area such as extractor fans, tumble dryers or boiler exhausts etc. This would also include other light sources such as security lights.
- Reflective surfaces (i.e. pools of water, white painted walls, overhanging branches and other types of foliage) may cause false activation under heightened weather conditions.
- During extreme weather conditions the PIR may exhibit unusual behaviour. Once normal weather resumes, the PIR will carryout normal operations.

5. Installation

- Ensure the mains supply is switched off and the circuit supply fuses are removed or the circuit breaker turned off.
- An isolating switch should be installed to enable the power to be switched ON and OFF to the luminaire. This allows the unit to be easily switched OFF for maintenance purposes.

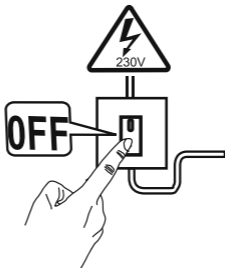

- Remove the wall plate from the light fitting, by removing the two nuts.

- Mark the position of the mounting holes on the wall using the wall plate as a template.

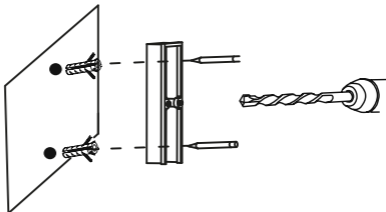

- Drill the holes for the wall plugs ensuring not to infringe on any gas/water pipes or electrical cables that may be hidden below/behind the surface.
- Pass through the mains supply cable into the wall plate via the grommet/cable gland ensuring there is a tight grip on the cable to maintain the IP rating of the luminaire.
- Mount the wall plate to the wall, using the fittings provided.

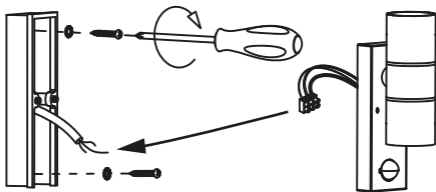

- Connect the mains supply to the relevant terminals ensuring the correct polarity is observed and that all bare conductors are sleeved (see section 5. Connection Diagram).

- Replace the luminaire over the wall plate, ensuring the gasket is in place, and tighten the two nuts hand tight, to secure the fitting.

6.Connection Diagram

- Connect the 230V AC 50Hz mains supply cable as follows;

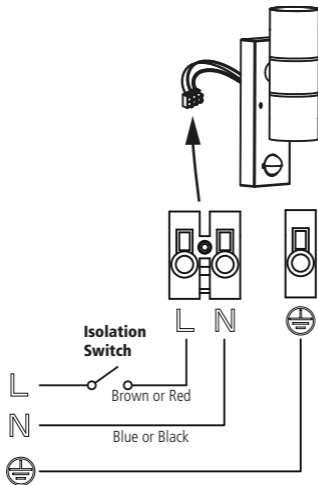

Note that the earth terminal is attached directly to the fitting. This is to ground the metallic exterior of the luminaire.

7. Commissioning and Operation

- Restore the power from the mains supply breaker or isolating switch and test for the correct operation.

Walk Test Procedure

- Adjust the time dial (fully anti-clockwise), and the Lux dial should be set to the minimum for daylight/night operation for the purpose of the walk test.
- Allow the PIR on the luminaire to settle down if the unit is switched on currently, this is called warm up mode.
- Once the unit is in the OFF position walk across the detection area, when the PIR is triggered and the lamp will turn ON for the minimum set amount of time.
- Once you are happy with the pickup area of the PIR you can set the Lux dial in the clockwise direction to trigger when dusk is approaching. (This may be best performed in real time in the evening subject to the users preference).
- You can also adjust the middle dial which will vary the sensitivity/range of the pickup area of up to 7m.

PIR Controls

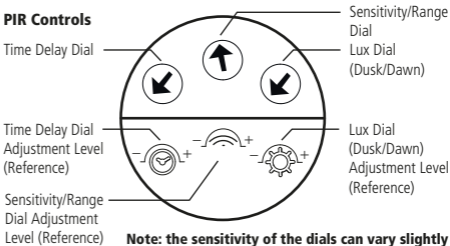

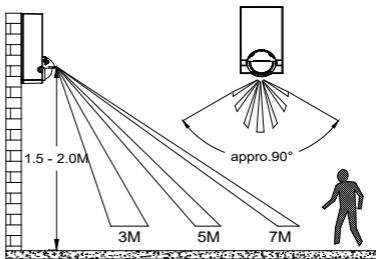

Detection Area

8. Manual Override

- The luminaire can be switched on for longer periods via the use of the manual override mode. This can be activated by using the internal wall switch. Switch the internal wall switch once OFF/ON within 2 seconds.
- The luminaire will continuously light for 6 hours, until the fitting is set back to auto mode. To return to auto mode, switch the internal wall switch OFF/ON again within 2 seconds.
- The unit will return to auto mode and now operate as setup after the walk test procedure.

9. Troubleshooting Guide

Problem	Cause/Solution
The luminaire does not switch on when in the detection area.	Bulb faulty or missing.
	Nearby light sources causing interference.
	Redirect the PIR or light source if possible.

Problem	Cause/Solution
False activation. (Luminaire switches on for no apparent reason)	Heat sources as described in section 4.
	Reflective surfaces described in section 4.
	Moving pedestrians, cars or animals in the area. Check the detection area.
	Nearby electromagnetic disturbance from a neighbouring circuit (CCTV interference).
Luminaire remains switched on	Continuous false activation resetting the delay time when an object is detected.
Luminaire switches on during daylight hours	Shadow casting over the PIR sensor
	Clouds creating a dark presence.
	Ensure the luminaire receives adequate daylight from all angles (not covered).

3 Year Guarantee

In the unlikely event of this product becoming faulty due to defective material or manufacture, within 3 years of the date of purchase, please return it to your supplier with proof of purchase and it will be replaced free of charge. For years 2 to 3 or with any difficulty in the first year, telephone our helpline. Note: a proof of purchase is required in all cases. For all eligible replacements (where agreed by Timeguard), the customer is responsible for all shipping/postage charges outside of the UK. All shipping costs are to be paid in advance before a replacement is sent.



If you experience problems, do not immediately return the unit to the store.

Email the Timeguard Customer Helpline:

HELPLINE

helpline@timeguard.com

or call the helpdesk on 020 8450 0515

Qualified Customer Support Coordinators will be online to assist in resolving your query.



A **theben** Group Company

For a product brochure please contact:

Timeguard Limited.

Victory Park 400 Edgware Road,
London NW2 6ND

Sales Office: 02084521112
or email csc@timeguard.com

www.timeguard.com

67.058.682 (Issue 1)